

XT75

System User Guide

Exported on 12/09/2024

Table of Contents

- 1 Get to Know Your System9**
- 1.1 Control Panel9
- 1.2 Keypad9
- 1.3 Prox Key.....9
- 1.4 Sensor.....9
- 1.5 Key Fob Remote9
- 1.6 Siren9
- 1.7 Smoke and Carbon Monoxide (CO) Detector9
- 1.8 Z-Wave.....10
- 1.9 Virtual Keypad™ App and VirtualKeypad.com™10
- 2 Use Your Keypad11**
- 2.1 Navigate the User Menu11
- 2.1.1 Command (CMD) 11
- 2.1.2 Back Arrow 11
- 2.1.3 Select Areas 11
- 2.2 Thinline Keypads.....12**
- 2.2.1 Options 13
- 2.2.2 Proximity Card Reader 13
- 2.2.3 Power and Armed LEDs..... 13
- 2.2.4 Select Keys 13
- 2.2.5 7/0 Panic Feature (Hardwired Systems Only)..... 14
- 2.3 Touchscreen Keypads14**
- 2.3.1 Options 15
- 2.3.2 Weather 15
- 2.3.3 Security Provider Logo 15
- 2.3.4 Proximity Card Reader (5-Inch Only)..... 15

2.3.5	Power and Armed LED (5-Inch Only)	16
2.3.6	Interactive Shield	16
2.3.7	Carousel Menu	16
2.4	Keypad Wi-Fi Setup (7-Inch Only)	18
2.5	System Status Icons.....	19
2.5.1	System Ready to Arm	19
2.5.2	Attention List.....	19
2.5.3	Battery Trouble.....	19
2.5.4	Chime On	20
2.5.5	AC Power Trouble	20
2.5.6	Wi-Fi Connection	20
3	Type On Your Keypad	21
3.1	Standard Keyboard	21
3.2	Number Pad	22
4	Know Your System Type.....	25
4.1	Area (A).....	25
4.2	All/Perimeter (All Perim)	25
4.2.1	All	25
4.2.2	Perimeter	25
4.3	Home/Sleep/Away (H S A).....	25
4.3.1	Home	25
4.3.2	Sleep	25
4.3.3	Away	26
5	Arm Your System	27
5.1	Area (A).....	27
5.1.1	Thinline and Wireless Touchscreen Keypads	27
5.1.2	Touchscreen Keypads	27
5.2	All/Perimeter (All Perim)	27

5.3	Home/Sleep/Away (H S A)	27
5.4	More Arming Options	27
5.4.1	Instantly Arm Your System.....	27
5.4.2	Use the Keypad Shortcut Keys	27
5.4.3	Bypass Zones.....	28
5.4.4	Extend Schedules.....	28
6	Disarm Your System	29
6.1	How to Handle an Alarm	29
6.1.1	Real Alarm	29
6.1.2	False Alarm	29
6.2	Disarm Your System	29
6.2.1	Thinline and Wireless Touchscreen Keypads	29
6.2.2	Touchscreen Keypads	29
6.2.3	Bluetooth Disarming (7-Inch Only).....	29
7	User Menu	35
7.1	Access the User Menu	35
7.2	Alarm Silence	35
7.2.1	Silence an Alarm:	35
7.3	Zone Activity Check	35
7.4	Sensor Reset	35
7.4.1	Reset All Sensors	35
7.5	Lockdown	36
7.5.1	Activate a Lockdown	36
7.5.2	Deactivate a Lockdown	36
7.6	Door Lock/Unlock	36
7.6.1	Lock or Unlock Your Doors.....	36
7.7	Door Access	36
7.7.1	Enable Door Access:.....	36

7.8	Armed Areas	36
7.8.1	Display Armed Areas	37
7.9	Outputs On/Off	37
7.9.1	Turn Outputs On and Off	37
7.10	Favorites	37
7.10.1	Begin Here	37
7.10.2	Add Devices to a Favorite	37
7.10.3	Edit Devices in a Favorite	37
	Lights	38
	Doors	38
	Thermostats	38
	Appliances (7-Inch Only)	38
7.10.4	Remove Devices in a Favorite	38
7.11	Z-Wave Setup	38
7.11.1	Begin Here	39
7.11.2	Add a Z-Wave Device	39
7.11.3	List Z-Wave Devices	39
7.11.4	Remove a Z-Wave Device	39
7.11.5	Status of a Z-Wave Device	39
7.11.6	Transfer Controller Operation	39
7.11.7	Optimize Z-Wave Devices	40
7.12	System Wi-Fi Setup	40
7.12.1	Begin Here	40
7.12.2	Use WPS to Connect Your System	40
7.12.3	List the Available Networks	40
7.12.4	Manually Connect Your System	40
7.12.5	Test the Network Connection	41
7.13	Zone Status	41
7.13.1	Check Zone Status	41
7.14	Bypass Zones	41

7.15 Zone Monitor.....41

7.15.1 Activate Zone Monitor 42

7.16 System Status42

7.16.1 Check Your System’s Status 42

7.17 System Test42

7.17.1 Test Your System..... 42

7.17.2 Test Your Zones..... 42

 Burglary Zones 42

 Panic Zones..... 42

7.18 User Groups43

7.18.1 User Groups Options Table 43

8 User Groups44

8.1 Begin Here44

8.2 Add a User Group44

8.3 Delete a User Group.....44

8.4 Change a User Group.....44

9 User Codes.....45

9.1 Begin Here45

9.2 Add a User Code.....45

9.3 Change a User Code45

9.4 Delete a User Code45

9.5 Send User Codes to Z-Wave Locks46

9.6 Ambush Code.....46

10 Schedules47

10.1 Begin Here47

10.2 Add a Schedule47

10.3 Delete a Schedule.....47

10.4 Change a Schedule47

10.5 Add Area, Door, and Output Schedules47

10.6 Add a Holiday Schedule48

10.7 Activate a Favorite Schedule48

10.8 Add a Temporary Schedule.....48

10.9 Time.....48

10.9.1 Adjust the Time and Date on Your Keypad..... 48

10.10 Display Events49

10.10.1 View Invalid Code Reporting with EasyEnroll..... 49

10.11 Service Request49

10.12 Fire Drill49

10.12.1 Start a Fire Drill Test 49

11 Evacuation Plan.....50

11.1 Draw a Floor Plan50

11.2 Develop Escape Routes50

11.3 Decide Where to Meet50

11.4 Practice Escape Plans50

11.5 Get Out Early51

12 Appendix52

12.1 User Authority Descriptions.....52

12.2 Add a User Code.....53

12.3 Change a User Code54

12.4 Common Keypad Displays54

13 Glossary57

13.1 Armed57

13.2 Card Reader57

- 13.3 Credential.....57**
- 13.4 Disarmed.....57**
- 13.5 False Alarm57**
- 13.6 Force Arm57**
- 13.7 Hardwired Systems57**
- 13.8 Monitoring Station.....57**
- 13.9 Outputs58**
- 13.10 Restored58**
- 13.11 System.....58**
- 13.12 Tripped.....58**

1 Get to Know Your System

Your system may not include all of the equipment and functions found in this guide.

1.1 Control Panel

The control panel acts as your system's brain. It communicates with the keypad and all the other system devices throughout the building.

1.2 Keypad

The keypad allows you to control your system from one place. You can use it to arm and disarm your system, add user codes, verify alarms, and many other functions.

1.3 Prox Key

A prox key is an impact resistant credential that fits on a standard key ring. It allows for codeless arming, disarming, and door access when it is presented to a reader.

1.4 Sensor

Sensors are small devices that monitor motion, temperature, flooding, breaking glass, and know when windows and doors have been opened.

1.5 Key Fob Remote

Depending on how your key fob remote is set up, it provides an easy way to arm and disarm your system or send a panic alarm.

1.6 Siren

The siren emits sound when your system goes into alarm.

1.7 Smoke and Carbon Monoxide (CO) Detector

These detectors notify you when smoke or carbon monoxide is present. Some detectors have an integrated synchronized sounder. If they are installed in groups, they will all sound simultaneously.

1.8 Z-Wave

Z-Wave devices allow you to control the lights, small appliances, garage doors, thermostats, and locks from the keypad, Virtual Keypad™ App and VirtualKeypad.com™.

1.9 Virtual Keypad™ App and VirtualKeypad.com™

The Virtual Keypad App and VirtualKeypad.com allow you to control and monitor your system on the go. The app is available for Apple and Android devices.

2 Use Your Keypad

2.1 Navigate the User Menu

2.1.1 Command (CMD)

Use **CMD** to move forward through each section of the user menu. You can also press **CMD** to save information you have just entered.

2.1.2 Back Arrow

Use the back arrow to back up one step while in the user menu. You can also press the back arrow once to erase the last character you entered.

2.1.3 Select Areas

Your keypad has a top row of select areas. Each time you press a select area, the keypad displays a function or series of options.

When there are more than four options available, press **CMD** to display the remaining options. Pressing the back arrow allows you to review the previous four choices.

2.2 Thinline Keypads

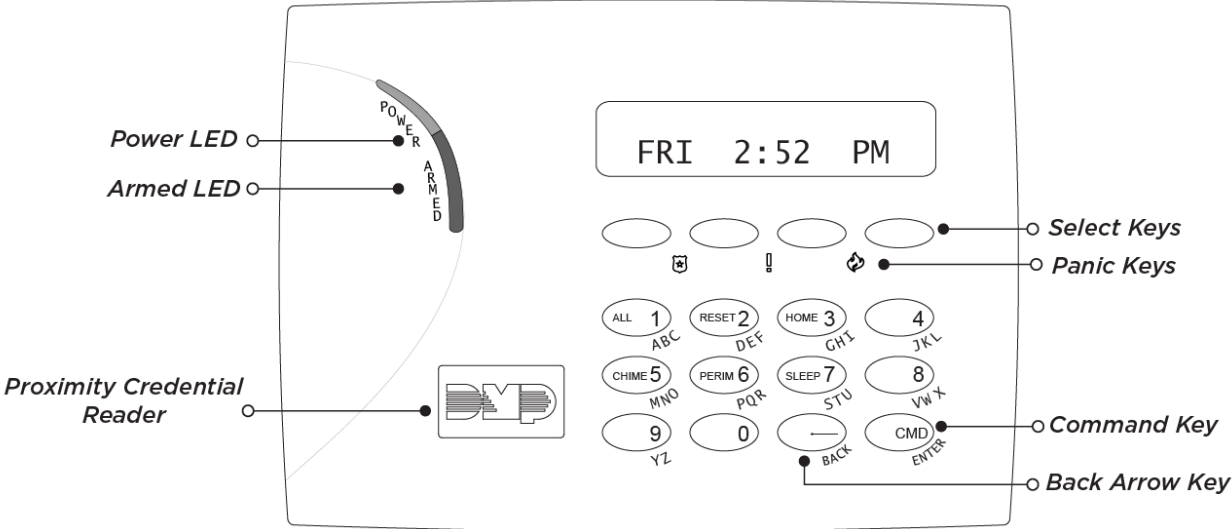

1 7000 Series Thinline Keypad

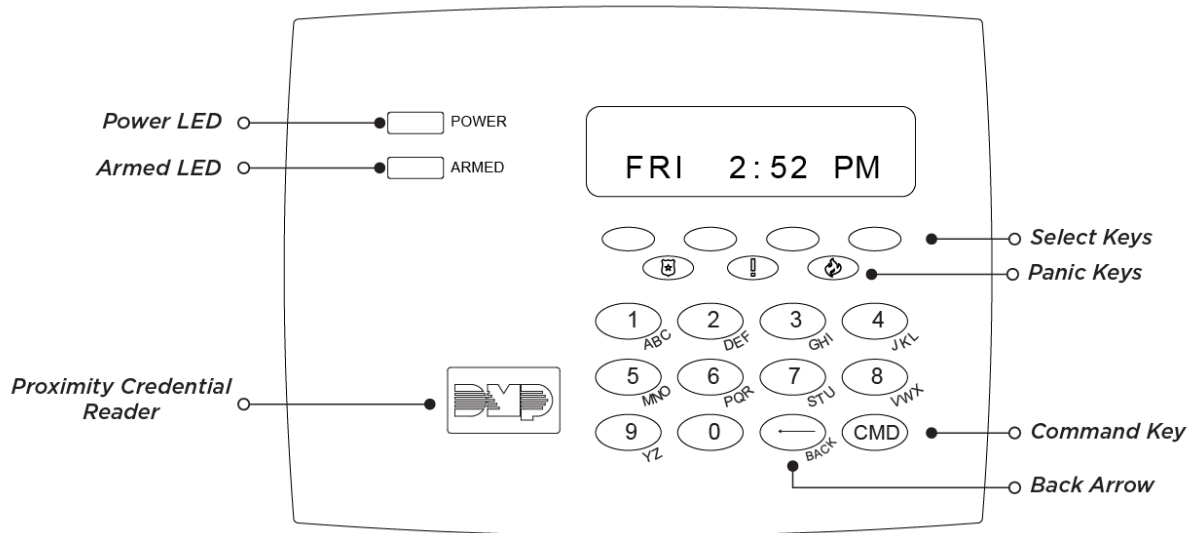

2 7100 Series Thinline Keypad

2.2.1 Options

On Thinline Keypads, press and hold the **CMD** and back arrow keys at the same time to access the Options Menu.

2.2.2 Proximity Card Reader

The keypad may have a built-in proximity card reader that allows you to arm or disarm your system when you present a credential.

2.2.3 Power and Armed LEDs

The AC Power and Armed LEDs indicate your system's power and armed status.

2.2.4 Select Keys

Use the select keys to type and navigate in the keypad.

2.2.5 7/0 Panic Feature (Hardwired Systems Only)

Press and hold the 7 and 0 keys at the same time to send a fire, emergency, or panic report to the emergency monitoring station.

2.3 Touchscreen Keypads

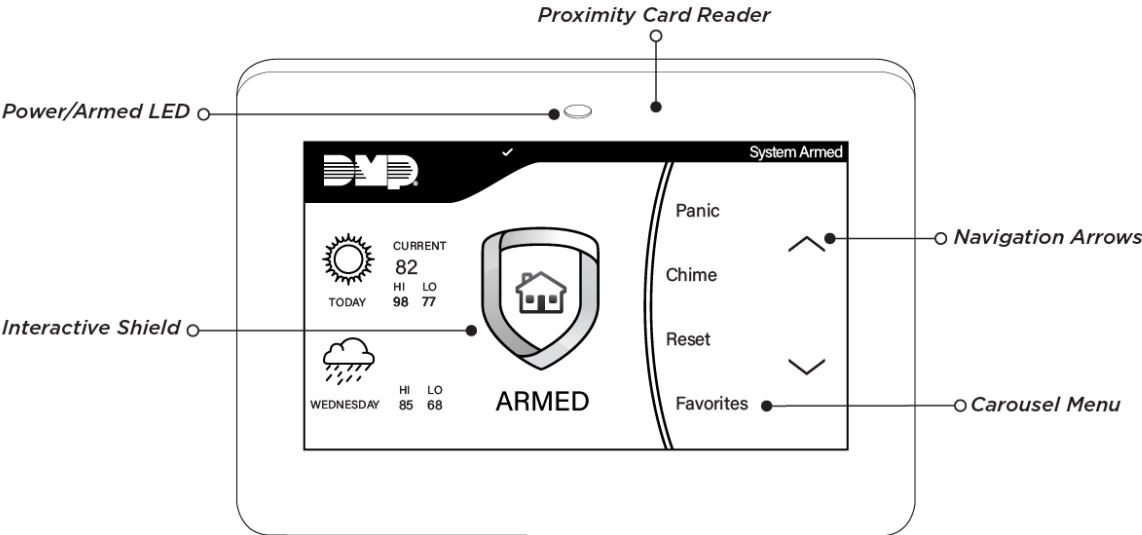

3 7800 Series Touchscreen Keypad

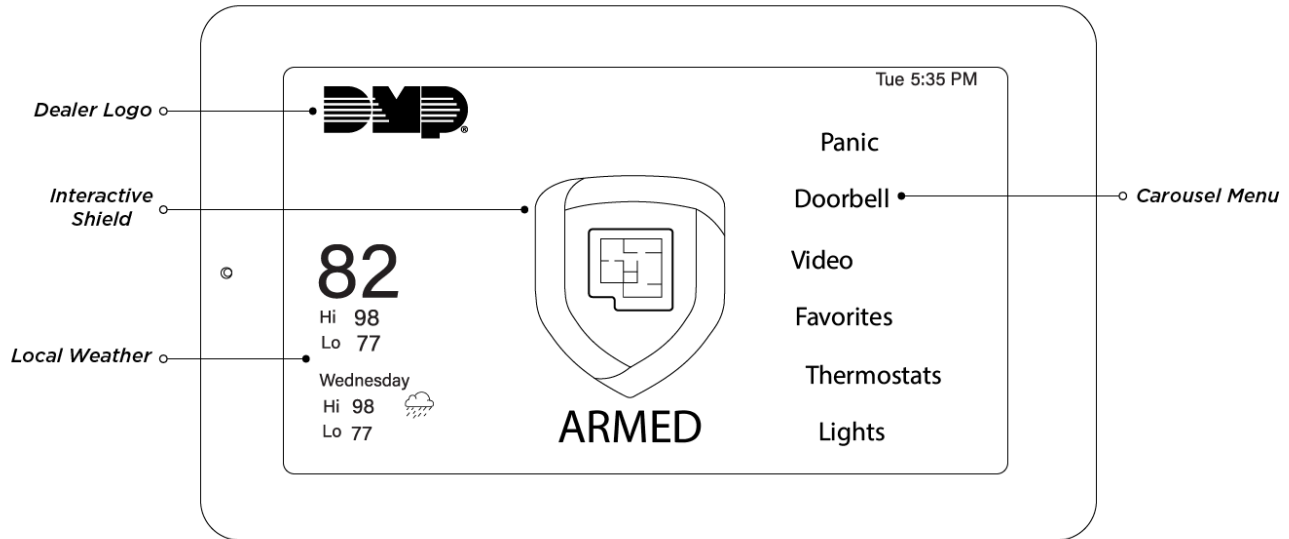

4 8860 Series Touchscreen Keypad

2.3.1 Options

On Touchscreen Keypads, press **Options** in the Carousel menu. From here, you can adjust the keypad brightness, tone, and volume.

If the keypad brightness is set to **0**, the keypad and LED will turn off when not in use. Brightness level **1** turns off the keypad when not in use, but the LED remains on.

2.3.2 Weather

Your system has been programmed to provide local weather information based on your zip code. Current weather conditions and forecasted HI and LOW temperatures are available on the home screen.

2.3.3 Security Provider Logo

Press the logo at the top of the keypad to bring up your security provider's contact information.

2.3.4 Proximity Card Reader (5-Inch Only)

Your keypad provides a built-in proximity card reader located to the right of the power/armed LED. Present your proximity card or key fob here to disarm your system.

2.3.5 Power and Armed LED (5-Inch Only)

The LED at the top-center of the keypad indicates the keypad's power status and your system's arming status. Depending on the status, the LED will be red or blue. See the table below for more information.

Color and Activity	Armed Status	Keypad Power Status
Blue Steady	Disarmed	AC Power OK, Battery OK
Blue Blinking	Disarmed	AC Power OK, Battery Trouble
No Light	Disarmed	AC Power Trouble, Battery OK
Red Steady	Armed	AC Power OK, Battery OK
Red/Blue Alternate	Armed	AC Power OK, Battery Trouble
Red Blinking	Armed	AC Power Trouble, Battery OK

2.3.6 Interactive Shield

On Touchscreen Keypads, press the shield to display your arming options. Disarm your system by pressing the shield and entering your user code.

2.3.7 Carousel Menu

On the 5-Inch Touchscreen Keypad, use the navigation arrows to scroll through the Carousel menu options. On the 7-Inch Touchscreen Keypad, press and drag to scroll through the Carousel menu options.

Carousel Menu Options for 5-Inch and 7-Inch Touchscreen Keypads	
Panic	Press Police , Emergency , or Fire to send a panic report to the emergency monitoring station.
Chime	Press Chime to turn the chime feature on and off. If chime is on, the keypad will sound an alert and display a notification when external doors and windows (with sensors installed) are opened.

Carousel Menu Options for 5-Inch and 7-Inch Touchscreen Keypads	
Reset	Press Reset to reset fire and panic sensors after they have triggered an alarm or after replacing batteries for wireless sensors.
Favorites	Favorites displays a list of your Z-Wave favorites. Press a Favorite to activate it.
Easy Exit	When your system is armed, press Easy Exit to allow you to leave through an exit door without triggering the alarm or needing to disarm and re-arm your system.
Options	Press Options to display the Setting Options screen. From here, you can adjust the keypad screen brightness, tone, and volume. You can also choose what you want to display in the carousel menu.
Keypad	Press Keypad to display a standard DMP keypad. Use this option to access the User Menu. See Type On Your Keypad for more information.
User Codes	Press User Codes to add, edit, or delete user codes in your system.
Schedules	Press Schedules to add, edit, or delete schedules. You can also use it to assign schedules to outputs and favorites, as well as auto-arming and auto-disarming.
Events (5-Inch Only)	Press Events on a 5-Inch Touchscreen Keypad to view up to 1,000 past panel events that occurred on your system over the last 45 days.
Events (7-Inch Only)	Press Events on a 7-Inch Touchscreen Keypad to view a combined events list from Virtual Keypad on your keypad.
Thermostats	Press Thermostats to display the Z-Wave thermostats screen. From here, you can adjust the temperature or select ON, OFF, HEAT, COOL, or FAN.

Carousel Menu Options for 5-Inch and 7-Inch Touchscreen Keypads

Doors	Press Doors to lock or unlock Z-Wave locks. You can also open and close Z-Wave-equipped garage doors.
Lights	Press Lights to turn ON , turn OFF , or DIM Z-Wave lights.
Appliances (7-Inch Only)	Press Appliances to display the Z-Wave appliances screen. From here, you can turn appliances on or off with the multilevel slider that displays.
Doorbell (7-Inch Only)	Press Doorbell to display a live view of a DMP Model V-4061DB Video Doorbell on the local network.
Video (7-Inch Only)	Press Video to display a live view of all system cameras on the local network.

2.4 Keypad Wi-Fi Setup (7-Inch Only)

Use this option to access additional features on your 7-Inch Touchscreen Keypad.

1. Select **Options** from the Carousel menu.
2. Select **Wi-Fi Settings**.
3. Select the Wi-Fi network you would like to connect to.
4. Enter the Wi-Fi password and select **CMD**.

Note: The 7-Inch Touchscreen Keypad needs to be connected to Wi-Fi to enable video features, events, and remote update capabilities.

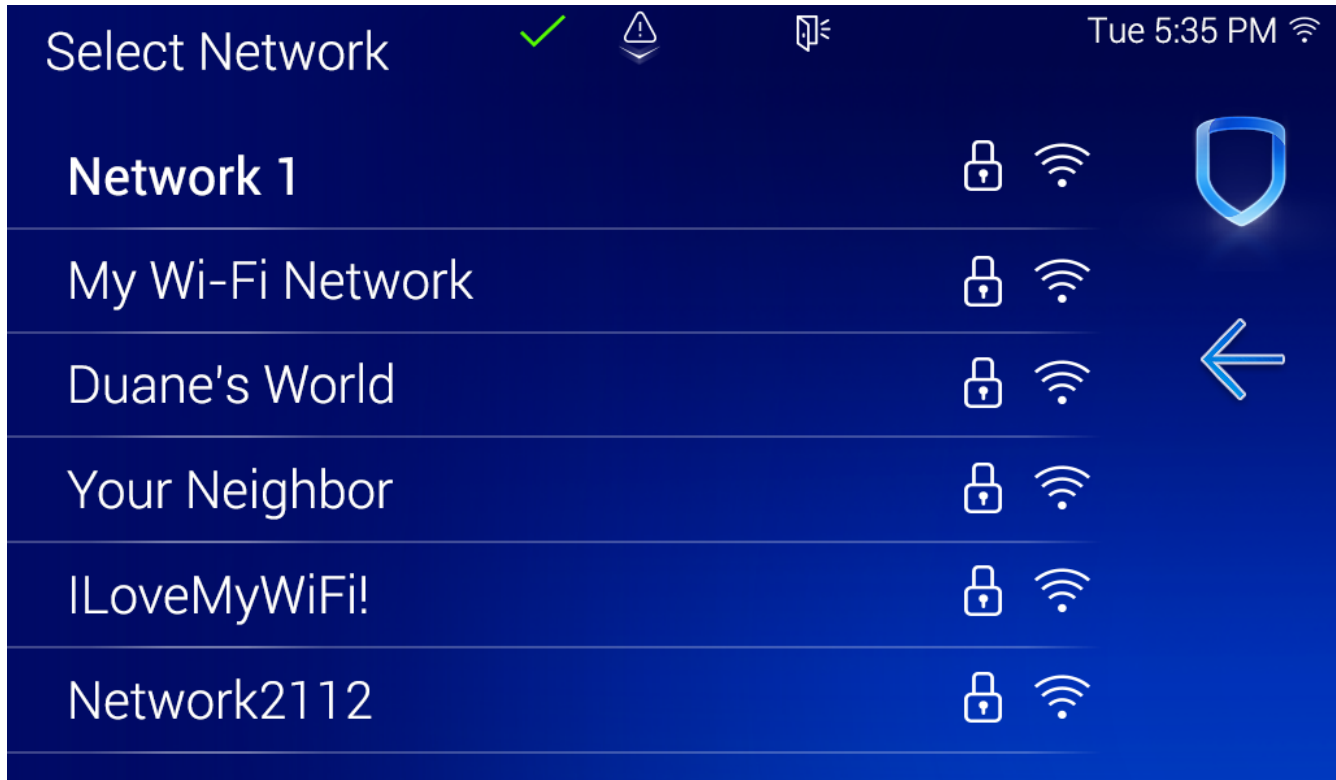

2.5 System Status Icons

System status icons for Touchscreen Keypads are located at the top of your home screen. The following icons indicate the status of your system:

2.5.1 ✓ **System Ready to Arm**

The check mark indicates that your system is ready to arm. If you don't see the check mark, a door or window may be open.

2.5.2 ⚠ **Attention List**

When pressed, the attention list icon displays the type of event or trouble message your system has recorded. It also shows the name and number of any affected zones.

2.5.3 🔋 **Battery Trouble**

If you see this icon, your system's battery is low or disconnected.

2.5.4 **Chime On**

This icon means your chime is turned on. A tone will sound each time a door or window is opened. You can activate this feature in the Chime section of the user menu.

2.5.5 **AC Power Trouble**

If you see this icon, your system isn't receiving AC power.

2.5.6 **Wi-Fi Connection**

If you see this icon, your system is connected to a Wi-Fi network.

3 Type On Your Keypad

All keypads offer the number pad, but only the Touchscreen Keypad Series offers the standard keyboard. Use the table and the keypad select areas that are shown in the graphics below to enter characters using the number pad. Follow the directions to enter characters using the standard keyboard.

3.1 Standard Keyboard

- Press **ABC** to access uppercase letters.
- Press **abc** to access lowercase letters.
- Press **!@#** to access symbols.
- Press **123** to access the number pad.



5 5-Inch Standard Keyboard and Select Areas

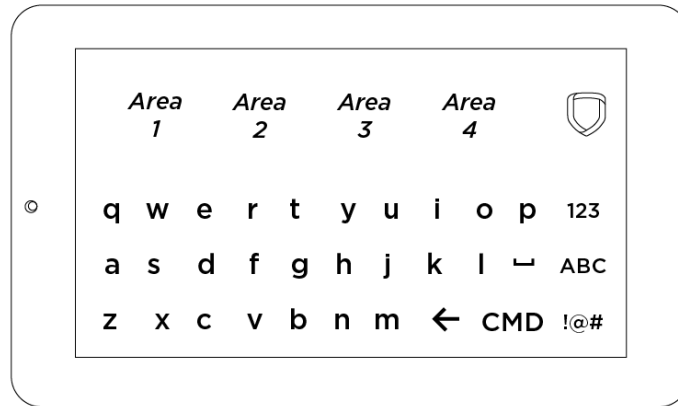

6.7-Inch Standard Keyboard and Select Areas

3.2 Number Pad

1. Choose a character from the table.
2. Identify the **Number** the character correlates with and press that character on the number pad.
3. Identify the **Select Key or Area** for that character and press that select key or area on the keypad. To access the lowercase letter, press that select key or area again.
4. When the desired character displays on the keypad, return to Step 1 to enter another character or press **CMD** if finished.

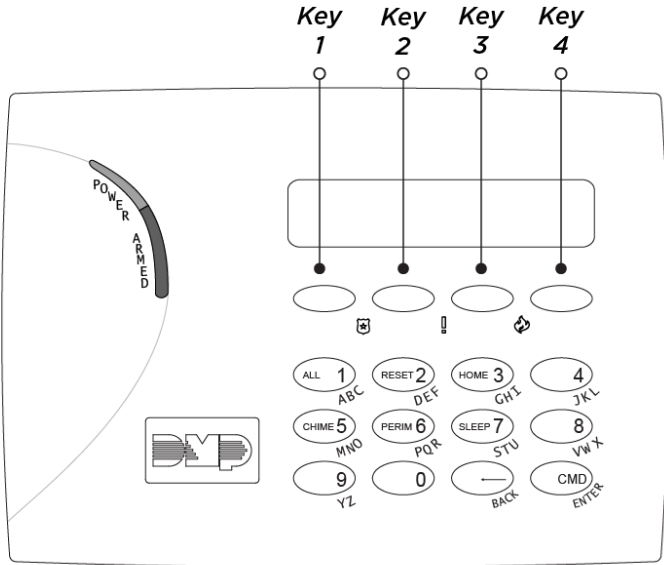

7 Thinline Series Number Pad with Select Keys

NUMBER	SELECT KEY			
	1	2	3	4
1	A	B	C	{ [({
2	D	E	F)] }
3	G	H	I	! ^ ~
4	J	K	L	? "
5	M	N	O	/ \ '
6	P	Q	R	& \$
7	S	T	U	@ %

8	V	W	X	, =
9	Y	Z	Space :	_ ;
0	- +	. '	• <	# >

4 Know Your System Type

Your system operates in one of the following ways: Area, All/Perimeter, or Home/Sleep/Away. Regardless of which system type you have, much of the operation is similar. The best way to identify your system type, is to arm it.

On a Thinline Keypad, press **CMD** until **ARM DISARM** displays, then press the select key under **ARM**. The arming options display. Identify your system type, then press the back arrow to exit the arming screen.

On a Touchscreen Keypad, touch the interactive shield and the arming options display. Identify your system type, then press the shield at the top of the keypad to exit the arming screen.

4.1 Area (A)

Your system can have up to 6 separate areas. Each area can do the following:

- Have a custom name.
- Arm or disarm independently of other areas.
- Limit access to users.

4.2 All/Perimeter (All Perim)

The building is divided into 2 main areas:

4.2.1 All

- Arms both the perimeter and the interior of the building.
- Use when you're leaving the building and no one remains inside.

4.2.2 Perimeter

- Arms just the perimeter of the building.
- Use when you're staying inside the building.

4.3 Home/Sleep/Away (H S A)

4.3.1 Home

- Arms the perimeter of the building.
- Use when you're staying in the building.

4.3.2 Sleep

- Arms the perimeter and a portion of the interior.
- Use to leave the bedroom areas of the building unarmed.

4.3.3 Away

- Arms the perimeter, interior, and bedrooms.
- Use when you're leaving the building and no one remains inside.

5 Arm Your System

5.1 Area (A)

5.1.1 Thinline and Wireless Touchscreen Keypads

1. Press **CMD** until **ARM DISARM** displays.
2. Select **ARM**. The keypad displays **ALL? NO YES**.
3. To arm all areas, select **YES**. To arm select areas, select **NO**. The keypad displays each area you have access to. Select **YES** to arm the areas and **NO** to leave the area disarmed.

5.1.2 Touchscreen Keypads

1. Press and release the shield to open the arming options screen.
2. Select **ARM**. The keypad displays a list of areas to arm.
3. To arm all areas, select **Arm All** at the right of the screen. To arm select areas, tap the area name and then select **Arm Selected** at the right of the screen.

5.2 All/Perimeter (All Perim)

1. Enter your user code and the keypad displays **PERIM ALL**.
2. Select **ALL** to arm all areas. The keypad displays **ALL SYSTEM ON**. Select **PERIM** to arm only the perimeter. The keypad displays **PERIMETER ON**.

5.3 Home/Sleep/Away (H S A)

1. Enter your user code and the keypad displays **H S A**.
2. Select **HOME** if you're staying inside the building, leaving the interior disarmed and arming the exterior. Select **SLEEP** to leave the bedroom areas disarmed, arming the interior and exterior areas. Select **AWAY** if no one will remain inside the building.

5.4 More Arming Options

5.4.1 Instantly Arm Your System

1. Press and release the shield on a 5-Inch or 7-Inch Touchscreen Keypad to open the arming options screen or press **CMD** on a Thinline keypad until **ARM DISARM** displays.
2. Select **INSTANT**. This overrides the entry and exit delay, instantly arming your system.

5.4.2 Use the Keypad Shortcut Keys

The keypads provide one-button shortcut keys. Press the key for two seconds until a tone sounds.

KEY	OPERATION
1	Arm Away for Home/Sleep/Away Systems Arm All for All/Perimeter systems
2	Fire and Panic Sensor Reset on all systems
3	Arm Home for Home/Sleep/Away systems
5	Monitor (Chime) on all systems
6	Arm Perimeter for All/Perimeter systems
7	Arm Sleep for Home/Sleep/Away systems
8	Easy Exit for Home/Sleep/Away systems

5.4.3 Bypass Zones

If a problem exists on any zone, the zone name and problem display, followed by **OK BYPASS STOP**.

- Press **OK** to force arm the zone. The zone will re-arm when it's restored.
- Press **BYPASS** to ignore the zone before arming. Panic, emergency, fire, flood detector, and temperature sensor zones cannot be bypassed.
- Press **STOP** to stop your system from arming. This allows you to correct the zone, return to the keypad, and restart the arming process.

5.4.4 Extend Schedules

When a schedule is active, you can extend the schedule to a later time. When arming your system, the keypad displays **LATE** or **CLOSING TIME!**.

1. Press any select key or area. The keypad displays **ENTER CODE:-**.
2. Enter your user code and press **CMD** or present your credential to a card reader.
3. The keypad displays **2HR 4HR 6HR 8HR**. Select the number of hours to extend the schedule.

6 Disarm Your System

6.1 How to Handle an Alarm

Enter your user code or present your credential to the keypad if it has a built-in proximity reader. You will see:

IS THIS A FALSE ALARM? YES NO or CANCEL VERIFY

6.1.1 Real Alarm

Press **NO** or **VERIFY** to notify the emergency monitoring station. Your system will remain armed.

6.1.2 False Alarm

Press **YES** or **CANCEL** to cancel the alarm. Your system will disarm.

6.2 Disarm Your System

6.2.1 Thinline and Wireless Touchscreen Keypads

1. Press **CMD** until **ARM DISARM** displays.
2. Select **DISARM**. The keypad displays **ALL? NO YES**.
3. To disarm all areas, select **YES**. To disarm select areas, select **NO**. The keypad displays each area you have access to. Select **YES** to disarm the areas and **NO** to leave the area armed.

6.2.2 Touchscreen Keypads

1. Press and release the shield to open the arming options screen.
2. Select **DISARM**. The keypad displays a list of areas to disarm.
3. To disarm all areas, select **Disarm All** at the right of the screen. To disarm select areas, tap the area name and then select **Disarm Selected** at the right of the screen.

6.2.3 Bluetooth Disarming (7-Inch Only)

Users can disarm their system with a Bluetooth device when their system is armed in **ALL** or **AWAY**. When the user returns and trips an exit zone, the entry delay will initiate and the keypad will begin scanning for Bluetooth devices. If the keypad discovers a previously paired device and connects to it, the system will disarm. Follow the steps below to pair your Bluetooth device to the keypad.

1. In **Options**, press **Bluetooth Settings**.
2. Enter your **User Code**. Only Master level user codes can access the Bluetooth Settings menu.
3. Press the Bluetooth toggle to enable the keypad's capability.
4. Press **+ Pair Device**.

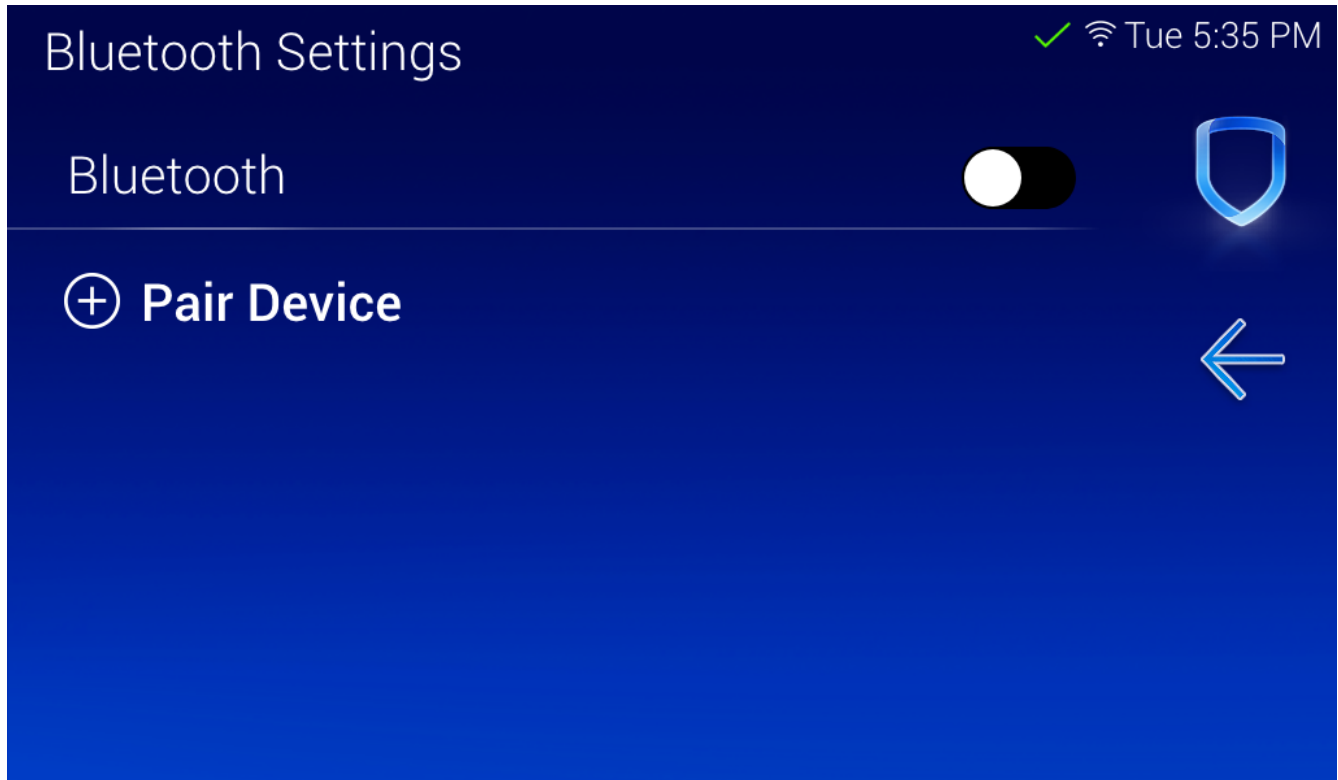

5. Select a user from the list and select the device you would like to attach the user to.
6. Press **Pair** in the bottom right corner.

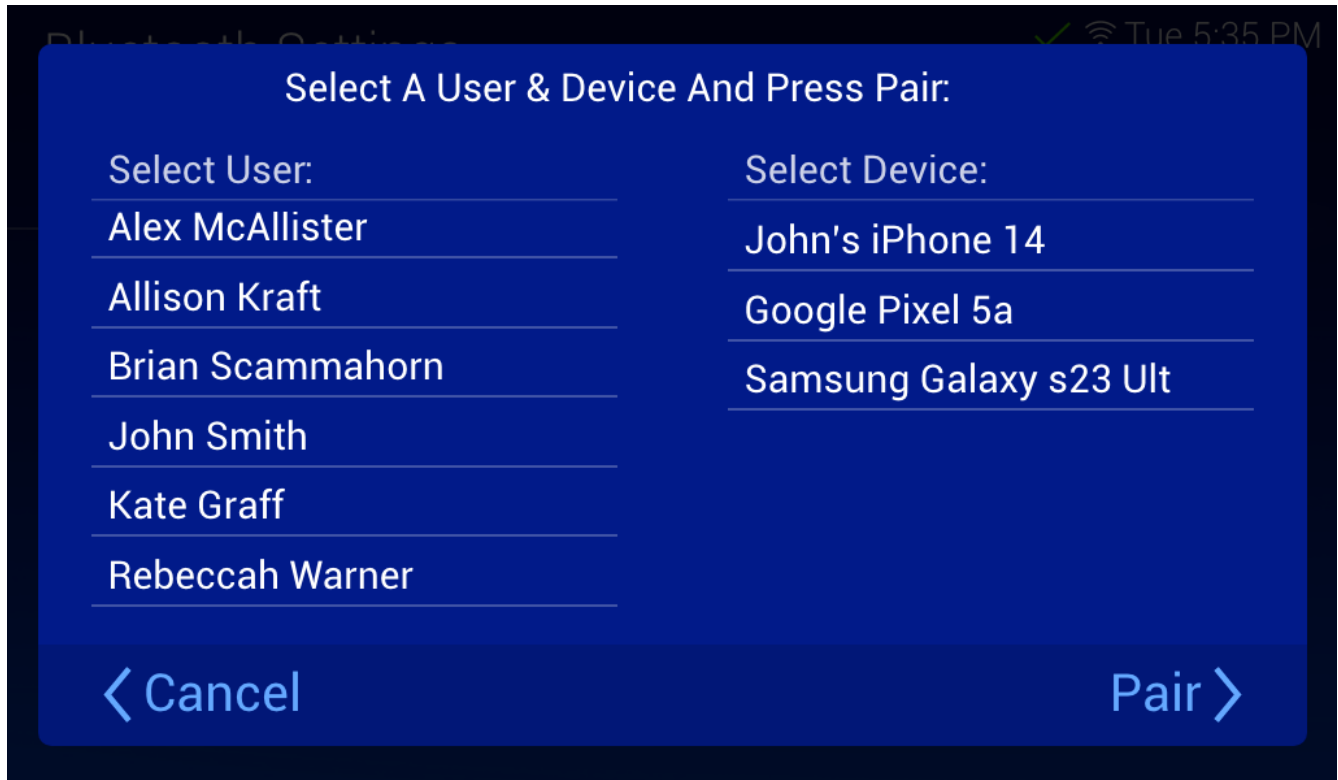

7. The keypad pop-up will display **Pairing**. This will last for 20 seconds or less.

If keypads were paired, the keypad will display **Pairing Success**. When the **Enable Bluetooth Pairing and Pair Device?** pop-up screen displays, press **Enable**. This will bring you back to the Bluetooth Settings menu. The name of the device will be listed under **Paired Devices**.

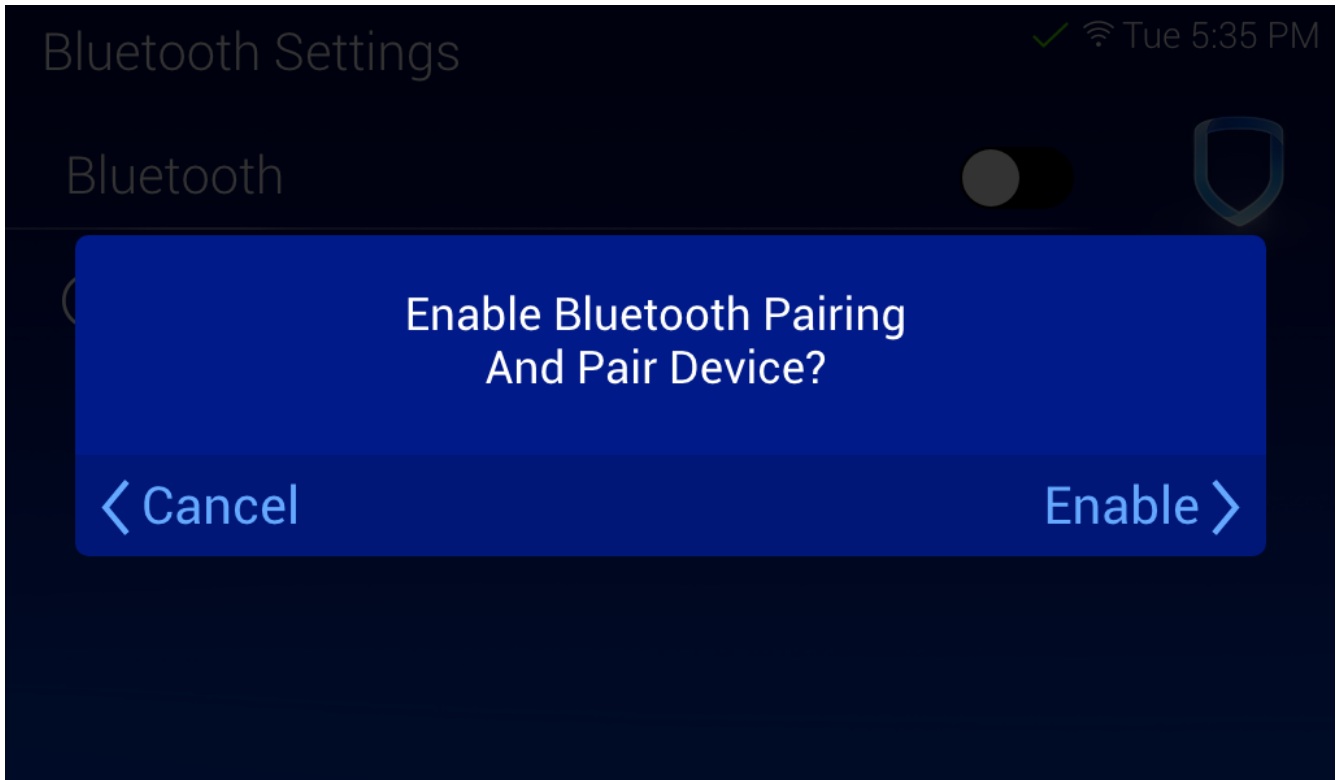

If devices were not paired, the keypad will display **Pairing Failed**. Press **Retry** to pair the devices again. Press **Cancel** to go back to the Bluetooth Settings menu.

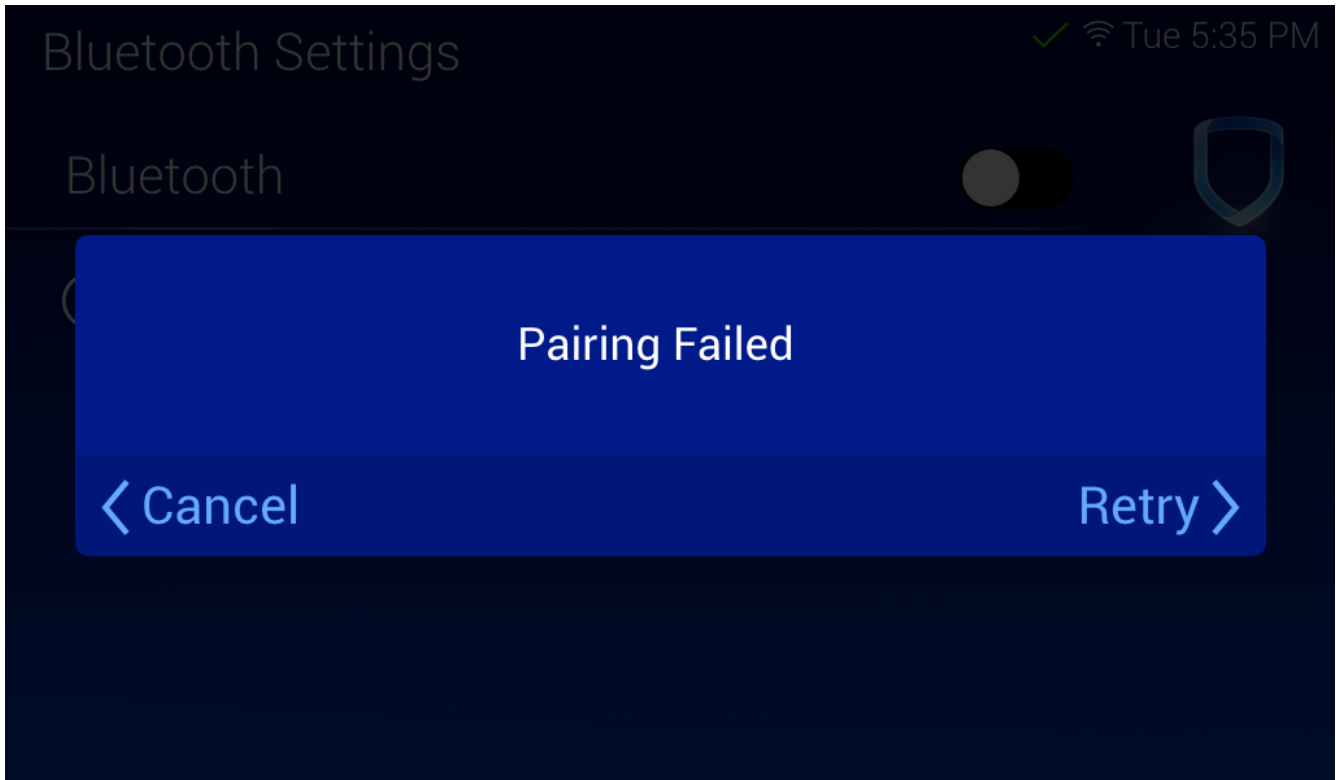

8. To unpair a device, press the Information icon next to the device name. The keypad will display the device name in a pop-up screen. Press **Forget Device** to unpair the device from the keypad. Press **Cancel** to go back to the Bluetooth Settings menu.

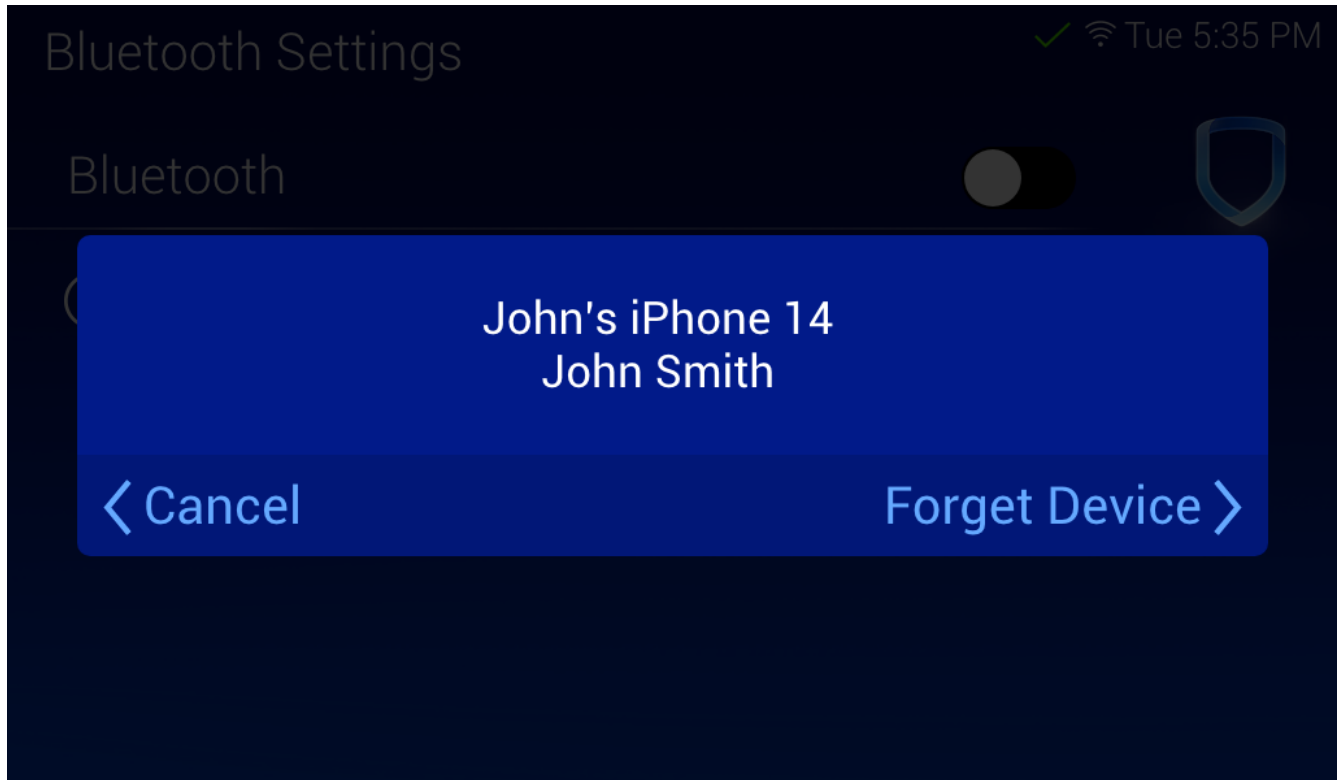

i Note: Up to 6 devices can be paired to the keypad. This feature is a per keypad operation. To use Bluetooth disarming at multiple keypads on a system, you will need to individually pair the device at each keypad you want to automatically disarm.

7 User Menu

You have access to many functions in the User Menu that can be accessed from the keypad. Enter your user code and the functions you have access to, display. The User Menu allows you to create user groups, add, change, and delete user codes, create favorites with your Z-Wave devices, and more. Below are the User Menu functions and their processes as you will see them on the keypad. Before using a function, you will need to access the User Menu.

7.1 Access the User Menu

1. Press **CMD** until **MENU? NO YES** displays.
2. Select **YES**.
3. Enter your user code and press **CMD**.

7.2 Alarm Silence

Alarm silence turns off your bells and sirens when your system is in alarm. It does not stop a report from being sent to the emergency monitoring station.

7.2.1 Silence an Alarm:

1. Access the User Menu.
2. At **ALARM SILENCE?**, press any select key or area to silence the bells or sirens.

7.3 Zone Activity Check

1. Access the User Menu.
2. Press **CMD** until **ACTIVITY CHECK?** displays.
3. Press any select key or area. The keypad displays **ENABLE? YES NO**. The default is **YES**.
 - When **NO** is selected, the keypad displays **CHECK DISABLED** for four seconds and then sends the Activity Check Disabled message to the central station.
 - When **YES** is selected, the keypad displays **CHECK ENABLED** for four seconds and then sends the Activity Check Enabled message to the central station.

7.4 Sensor Reset

Sensor Reset resets panic and fire sensors after they have been tripped. They must be reset before they can detect any additional alarm conditions. A sensor reset is also required after replacing batteries in wireless devices.

7.4.1 Reset All Sensors

1. Access the User Menu.
2. Press **CMD** until **SENSOR RESET?** displays.
3. Press a top row select key or area. The keypad displays **SENSORS OFF** followed by **SENSORS ON**.

7.5 Lockdown

Activate a lockdown to immediately lock all public doors connected to your system. Deactivate a lockdown by allowing an authorized user to perform a Sensor Reset at the keypad.

7.5.1 Activate a Lockdown

1. Access the User Menu.
2. Press **CMD** until **LOCKDOWN?** displays.
3. Press any select key or area to lock all public doors.

7.5.2 Deactivate a Lockdown

1. Access the User Menu if Sensor Reset and Lockdown Override are enabled in your profile.
2. Press **CMD** until **SENSOR RESET?** displays.
3. Press a top row select key or area. The keypad displays **SENSORS OFF** followed by **SENSORS ON**, returning all public doors back to their previous state.

7.6 Door Lock/Unlock

7.6.1 Lock or Unlock Your Doors

1. Access the User Menu.
2. Press **CMD** until **DOOR LOCK/UNLOCK?** displays.
3. Press a top row select key or area. Enter the door number and press **CMD** or select **LIST** to browse doors.
4. Press the select key or area over the desired option.

7.7 Door Access

Door access is granted when an authorized credential is presented to a door access reader. The door momentarily unlocks, allowing the user to enter, then re-locks.

7.7.1 Enable Door Access:

1. Access the User Menu.
2. Press **CMD** until **DOOR ACCESS?** displays.
3. Press any select key or area to allow momentary access.

7.8 Armed Areas

Use this function to list your system's areas that are currently armed.

7.8.1 Display Armed Areas

1. Access the User Menu.
2. Press **CMD** until **ARMED AREAS?** displays.
3. Press any select key or area. Press **CMD** to advance through the list of armed areas.

7.9 Outputs On/Off

Use this function to individually turn your system's outputs on and off. Your system may use outputs to control door access, interior and exterior lighting, heating, air conditioning, and other appliances.

7.9.1 Turn Outputs On and Off

1. Access the User Menu.
2. Press **CMD** until **OUTPUTS ON/OFF** displays.
3. Press any select key or area.
4. Enter the output number, then select **ON** or **OFF**.

7.10 Favorites

Favorites are preset combinations that allow you to quickly activate multiple Z-Wave devices at once. You can create a Favorite that turns down your thermostat, turns off your lights, and locks your front door when you leave the building. You can add up to 25 devices to a Favorite.

7.10.1 Begin Here

1. Access the User Menu.
2. Press **CMD** until **ZWAVE SETUP?** displays.
3. Press any select key or area. The keypad displays **ADD LIST REMOVE**. Press **CMD** to display **FAV XFER OPT**.
4. Select **FAV**. At **FAVORITE NUMBER:**, enter a number between 1 and 20 and press **CMD**. **ADD EDIT REMOVE** display.

Note: To access favorites on 7-Inch Touchscreen Keypads, press Favorite or the Z-Wave device in the Carousel menu. Press the Settings icon in the bottom right corner to configure device settings.

7.10.2 Add Devices to a Favorite

1. Select **ADD**.
2. Press **CMD** to browse your Z-Wave devices.
3. Press any select key or area to assign a device to a Favorite.

7.10.3 Edit Devices in a Favorite

1. Select **EDIT**.

2. Press **CMD** to browse your Z-Wave devices.
3. Press any select key or area to view a device's settings. Refer to the Lights, Doors, and Thermostat sections on this page to edit your devices.

Lights

Press the select key or area for the desired setting when **SETTING: ON OFF DIM** displays.

- Select **ON** or **OFF** to turn a device on or off.
- Select **DIM**, enter the dim level (1-10) of the device, and press **CMD**.

Doors

- Doors: Press the select key or area for the desired setting when **SETTING: LOCK UNLOCK** displays
- Garage Doors: Press the select key or area for the desired setting when **SETTING: OPEN CLOSE** displays.

Thermostats

Press the select key or area for the desired setting when **SETTING: OFF CL HT** displays.

Off

1. Select **OFF** to display **FAN SETTING:**.
2. Press any select key or area. When **ON AUTO** displays, press the select key for the desired option.

Cool

1. Select **CL** and press any select key or area.
2. Enter the new temperature and press **CMD**.

Heat

1. Select **HT** then press any select key or area.
2. Enter the new temperature and press **CMD**.

Appliances (7-Inch Only)

Use the multilevel slider on the right side of the device to set the device at 0, 25, 50, 75, or 100. 0 is **Off** and 100 is **On**.

7.10.4 Remove Devices in a Favorite

1. Select **REMOVE** then press **CMD** to view your devices.
2. When the desired device displays, press any select key or area to remove that device.
3. Select **YES** when **REMOVE DEVICE FROM FAV? NO YES** displays.

7.11 Z-Wave Setup

Z-Wave technology adds home automation to your system. Using Z-Wave, you can control lights, locks, small appliances, and thermostats from your keypad, Virtual Keypad App, or VirtualKeypad.com. You can add up to 140 Z-Wave devices to your system.

7.11.1 Begin Here

1. Access the User Menu.
2. Press **CMD** until **ZWAVE SETUP?** displays.
3. Press any select key or area. The keypad displays **ADD LIST REMOVE**. Press **CMD** to display **FAV XFER OPT**.

Note: To access favorites on 7-Inch Touchscreen Keypads, press Favorite or the Z-Wave device in the Carousel menu. Press the Settings icon in the bottom right corner to configure device settings.

7.11.2 Add a Z-Wave Device

1. Select **ADD**.
2. Press the button on the Z-Wave device when **PRESS BUTTON ON DEVICE TO ADD** displays on the keypad.
3. Press **CMD** when **DEVICE FOUND** displays.
4. Press any top row select key or area and name the device.
5. Press **CMD** to save the device.

7.11.3 List Z-Wave Devices

1. Select **LIST** and **DEVICE LIST** displays.
2. Press **CMD** to advance through the list of Z-Wave devices.
3. Press any select key or area to display **DEVICE RENAME STATUS**.
4. Select **RENAME** and name the device then press **CMD**.

7.11.4 Remove a Z-Wave Device

1. Select **REMOVE**.
2. Press the button on the Z-Wave device when **PRESS BUTTON ON DEVICE TO REMOVE** displays on the keypad.

7.11.5 Status of a Z-Wave Device

1. Select **LIST** and **DEVICE LIST** displays.
2. Press **CMD** to advance through the list of Z-Wave devices.
3. Press any select key or area to display **DEVICE RENAME STATUS**.
4. Select **STATUS**. The device name and OKAY display when the device communicates. The device name and **FAILED** display if the device stored in the system does not communicate.
5. Press **CMD** and **REMOVE FAILED DEVICE** displays.
6. Select **YES** to remove the failed device from your system. Select **NO** to leave the device in your system.

7.11.6 Transfer Controller Operation

Use this function to transfer and replace your existing Z-Wave device information with information from another system.

1. Select **XFER**. The keypad warns you that transferring Z-Wave device information deletes all your Z-Wave devices connected to your system.
2. Select **YES** to proceed.
3. Initiate the transfer at the other manufacturer's Z-Wave portable controller. **ZWAVE SETUP?** displays.

7.11.7 Optimize Z-Wave Devices

Select **OPT**. The keypad displays **OPTIMIZE SUCCESS** when communication with a Z-Wave device is established.

7.12 System Wi-Fi Setup

Use this function if your system is connected through Wi-Fi.

7.12.1 Begin Here

1. Access the **User Menu**.
2. Press **CMD** until **WIFI SETUP?** displays.
3. Press any select key or area and the keypad displays **WPS LIST MANUAL**. Press **CMD** to display **TEST**.

7.12.2 Use WPS to Connect Your System

1. Press the WPS button on your Wi-Fi router.
2. Select **WPS** on your keypad and **SEARCHING** displays.
3. When WPS is successful, **CONNECTED** displays on your keypad. If WPS was not successful, **WPS FAILED RETRY? NO YES** displays.
4. Press **YES** to retry. Press **NO** and **WPS LIST MANUAL** displays.

7.12.3 List the Available Networks

1. Select **LIST** and **SEARCHING** displays.
2. Press **CMD** to view the available Wi-Fi networks.
3. When the desired network displays, press any select key or area to connect. **W/L KEY:******* displays.
4. If the system is unable to detect the security type, press any select key or area on the keypad and **WEP WPA NONE** displays. Select the desired security type and enter your network password. See Type On Your Keypad.

7.12.4 Manually Connect Your System

1. Select **MANUAL**.
2. Enter the name of your Wi-Fi network and press **CMD**. **W/L KEY:******* displays.
3. If the system is unable to detect the security type, press any select key or area on the keypad and **WEP WPA NONE** display. Select the desired security type then enter your network password. See Type On Your Keypad.

7.12.5 Test the Network Connection

Select **TEST**. When the test is successful, **CONNECTED** displays. If the test is unsuccessful, **NOT CONNECTED** displays.

7.13 Zone Status

Zone status allows you to check the status of each zone, displaying a list of armed, bypassed, and alarmed zones.

7.13.1 Check Zone Status

1. Access the User Menu.
2. Press **CMD** until **ZONE STATUS?** displays.
3. Press any select key or area to display **ARM BYPS ALR NBR**.
 - Select **ARM** for a list of currently armed zones.
 - Select **BYPS** for a list of currently bypassed zones.
 - Select **ALR** for a list of currently alarmed zones.
 - Select **NBR** to find a specific zone number.
4. Select the desired option and the zones related to that option display with a zone status of **OKAY**, **BYPS**, or **BAD**.

7.14 Bypass Zones

Follow these steps to bypass a zone from the User Menu. Fire, panic, emergency, supervisory, and 24-hour zones cannot be bypassed.

1. Access the User Menu.
2. Press **CMD** until **BYPASS ZONES?** displays.
3. Press any select key or area. The keypad displays **ZONE: - RST BYPS**.
4. To bypass a zone, enter the zone number and select **BYPS**. The zone number automatically disappears and a new zone number can be entered. Refer back to step 3. Confirmation will be given when the zone has been bypassed.
5. To restore a zone, enter the zone number and select **RST**. Confirmation will be given when the zone is restored.

 **Note:** Bypass can be accessed through the Carousel menu on Touchscreen Series Keypads.

7.15 Zone Monitor

If a door or window is opened when the system is disarmed, the keypad sounds a chime and displays the zone on the keypad.

7.15.1 Activate Zone Monitor

1. Access the User Menu.
2. Press **CMD** until **ZONE MONITOR?** displays.
3. Press any select key or area and the keypad displays **ALL NBR** or **PERIM ALL NBR**. Select the desired option.
 - Select **ALL** to add or remove devices from zone monitor.
 - Select **NBR** to enter a specific zone number.
 - Select **PERIM** to monitor all Night and Exit zones.

7.16 System Status

This option allows you to check the current status of your system.

7.16.1 Check Your System's Status

1. Access the User Menu.
2. Press **CMD** until **SYSTEM STATUS?** displays.
3. Press any select key or area. Press **CMD** to advance through the system status list. If **TRBL** displays, call your service department for assistance.

7.17 System Test

7.17.1 Test Your System

1. Access the User Menu.
2. Press **CMD** until **SYSTEM TEST?** displays and press any select key or area.
3. At **SYSTEM ZONES**, select **SYSTEM**. The system test automatically begins.

7.17.2 Test Your Zones

Burglary Zones

1. Select **ZONES**. The keypad displays **BURG**.
2. Select **BURG** and manually trip each burglary zone.
3. Select **END** to stop the test. **BURG TEST OKAY** displays when the test is complete and all zones tested okay.

Panic Zones

1. Select **ZONES**. The keypad displays **BURG PANICS**.
2. Select **PANICS** and the manually trip each burglary zone.
3. Select **END** to stop the test. **PANIC TEST OKAY** displays when the test is complete and all zones tested okay.

7.18 User Groups

Groups define the authorities for each user code in the system. Each user can be assigned up to four groups. Ensure at least one administrator on your system has a group assigned with all authorities and all areas.

7.18.1 User Groups Options Table

Use the User Groups options table below to familiarize yourself on how to create a user group.

User Group Options	
Group Name/Number	Assign each group a name and specific number from 1-10.
Arm/Disarm Areas	Assign each group specific areas to arm and disarm.
Access Doors	Assign each group door access assignments.
User Menu Assignments	Assign each group specific authorities. See the User Group Chart.

8 User Groups

8.1 Begin Here

1. Access the User Menu.
2. Press **CMD** until **USER GROUPS?** displays.
3. Press any select key or area. The keypad displays **ADD DEL CHG**.

8.2 Add a User Group

1. Select **ADD**.
2. Enter an unused **GROUP NO:** and press **CMD**.
3. Press any select key or area and enter a **GROUP NAME**, then press **CMD**.
4. At **DOORS:** select the doors the user can access and press **CMD**.
5. At **AREAS:**, select the area numbers the user can access and press **CMD**.
6. The keypad displays **GROUP ## ADDED** when the user group has been successfully added.

8.3 Delete a User Group

1. Select **DEL**.
2. Enter a **GROUP NO:** and press **CMD**. The keypad displays **GROUP DELTD** when a user group is successfully deleted.

8.4 Change a User Group

1. Select **CHG**.
2. Enter a **GROUP NO:**, and press **CMD** twice. The keypad displays each menu option. Select **YES** or **NO** for each menu item, then press **CMD** to advance through the menu options. The keypad displays **GROUP CHNGD** when the group is successfully changed.

XT75 panels support a three to six digit code that allows you to do several things from the keypad, Virtual Keypad App, or VirtualKeypad.com. Every user in the system should be assigned a user code. A user code is made up of the following elements: User Number, User Code, User Name, and Authority Level.

9 User Codes

XT75 panels support a three to six digit code that allows you to do several things from the keypad, Virtual Keypad App, or VirtualKeypad.com. Every user in the system should be assigned a user code. A user code is made up of the following elements: User Number, User Code, User Name, and Authority Level.

9.1 Begin Here

1. Access the User Menu.
2. Press **CMD** until **USER CODES?** displays. Press any select key or area. The keypad displays **ADD DEL CHG BAT**. Press **CMD** to display **FRGV SEND**.

9.2 Add a User Code

1. Select **ADD**.
2. Enter a **USER NUMBER** and press **CMD**.
3. When **ACTIVE?** displays, select **YES** to make the user code active, or select **NO** to make the user code inactive. Press **CMD**.
4. When **TEMP CODE?** displays, select **YES** to make the temporary code active, or select **NO** to make it inactive. If **YES** is selected, you will be prompted to enter a start date and an expiration date for the temporary user code.
5. Enter a **USER CODE** and press **CMD**. If you are using an access card, present the card to the reader instead of entering a code.
6. Press a top row select key or area and enter a **USER NAME**. Press **CMD**.
7. Enter a **GROUP NO:**, and press **CMD**. The keypad displays **USER # ADDED** when the user code has been successfully added.

9.3 Change a User Code

1. Select **CHG**.
2. Enter the current user number and press **CMD**.
3. When **ACTIVE?** displays, select **YES** to make the user code active, or select **NO** to make the user code inactive. Press **CMD**.
4. When **TEMP CODE?** displays, select **YES** to make the temporary code active, or select **NO** to make it inactive. If **YES** is selected, you will be prompted to enter a start date and an expiration date for the temporary user code.
5. Press any select key or area and enter the new user code. Press **CMD**.
6. Press any select key or area to clear the displayed name and enter a new name, if desired. Press **CMD**. See Type On Your Keypad.
7. Enter a **GROUP NO:** and press **CMD**. The keypad displays **USER # CHNGD** when the user code is successfully changed.

9.4 Delete a User Code

1. Select **DEL**.

2. Enter the **USER NUMBER** you want to delete and press **CMD**. The keypad displays **USER # DELTD** when the user code is successfully deleted.

9.5 Send User Codes to Z-Wave Locks

Select **SEND**. When user codes 2-20 are successfully sent to your compatible Z-Wave locks, the keypad exits the User Menu. If a user code is not received, the keypad displays **CODES NOT SENT TO ALL DOORS**.

9.6 Ambush Code

If your system was programmed to allow user number 1 to be used as an Ambush code and when this code is entered at the keypad, a silent alarm is sent to your monitoring station. This silent alarm alerts the operator to a duress situation at the premises and prompts immediate notification of authorities.

10 Schedules

Schedules allow you to set recurring times when your system arms or disarms. You can also set schedules for when you want your Z-Wave devices to turn on and off.

10.1 Begin Here

1. Access the User Menu.
2. Press **CMD** until **SCHEDULES?** displays. Press any select key or area.
3. At **ALL TEMP**, select **ALL** to add, change, or delete a schedule. Select **TEMP** to add a temporary schedule. The keypad displays **TIMES AREAS DOORS**. Press **CMD** to display **OUTPUT HOLIDAYS**. Press **CMD** to display **FAVORITES**.

10.2 Add a Schedule

1. Select **TIMES**. The keypad displays **ADD DEL CHG**.
2. Select **ADD**.
3. Enter the new schedule number (1-10) and press **CMD**.
4. Press a top row select key or area and enter a **SCHEDULE NAME**. Press **CMD**.
5. Select the day you want to add a schedule to. Press **CMD** to display **THU FRI SAT HOL**.
6. At **ENTER BEGIN TIME -:**, enter the opening time and select **AM** or **PM**. Enter all times using a 12-hour clock.
7. At **ENTER END TIME -:**, enter the end time and select **AM** or **PM**.

10.3 Delete a Schedule

1. Select **TIMES**, then select **DELETE**.
2. Enter the schedule number (1-10) and press **CMD**.
3. At **DELETE SCHEDULE SURE? YES NO**, select **YES**.

10.4 Change a Schedule

1. Select **TIMES**, then select **CHG**.
2. Enter the schedule number that's changing and press **CMD**.
3. The keypad displays **ENTER SCHEDULE** and the schedule name. Press any select key or area to change the schedule name and press **CMD**.
4. Select the day you want the schedule to begin. Press **CMD** to display to display **THU FRI SAT HOL**.
5. At **ENTER BEGIN TIME -:**, enter the opening time and select **AM** or **PM**. Enter all times using a 12-hour clock.
6. At **ENTER END TIME -:**, enter the end time and select **AM** or **PM**.

10.5 Add Area, Door, and Output Schedules

1. Select either **AREAS**, **DOOR**, or **OUTPUT**.
2. At **ENTER area/door/output NUMBER:-**, enter the number you want to assign that schedule and press **CMD**.

3. At **SCHEDULE NO:-**, press any select key or area and enter the number. Press **CMD**.

10.6 Add a Holiday Schedule

Adding Holiday Dates provide the system with dates in the year when the normal opening and closing schedules are not used and replaced by one of the Holiday Schedules A or B or C. Up to forty different holiday dates can be entered. For holidays that fall on a different date each year, be sure to update their programmed Holiday Dates annually.

1. Select **HOLIDAY**.
2. At **HOL:**, press the fourth select key or area to access **HOL B** or **HOL C**.
3. Press **CMD** to advance through the list of holidays.

10.7 Activate a Favorite Schedule

1. Select **FAVORITES**.
2. Press any select key or area.
3. Enter a **FAVORITE NUMBER** or select **LIST** to browse the list of existing favorite numbers.
4. Press **CMD** when the desired favorite number displays. The keypad displays **FAVORITE ACTIVATED** when a Favorites schedule is successfully activated.

10.8 Add a Temporary Schedule

1. Select **TEMP**.
2. Select the type of temporary schedule you are creating: area, door, output, or favorite. (Press **CMD** to display **FAVORITE**)
 - Area or Door*
At **NUM: ALL NONE**, enter a specific area or door number. Select **ALL** to create a schedule for all areas or doors.
 - Output or Favorite*
At **NUM: LIST**, enter a specific output or favorites number, or select **LIST** to view a list of available areas or doors.
3. After selecting an option from above, select the day you want the schedule to begin. Press **CMD** to display to display **THU FRI SAT HOL**.
4. At **ENTER BEGIN TIME -:**, enter the opening time and select **AM** or **PM**. Enter all times using a 12 hour clock. Press **CMD**.
5. At **ENTER END TIME -:**, enter the end time and select **AM** or **PM**, and press **CMD**.
6. At **ENTER START DATE**, enter the month and day you want the schedule to start on and press **CMD**.
7. At **ENTER END DATE**, enter the month and day you want to the schedule to end on and press **CMD**.
8. Press **CMD** to save the temporary schedule.

10.9 Time

10.9.1 Adjust the Time and Date on Your Keypad

1. Access the User Menu.
2. Press **CMD** until **TIME?** displays. Press any select key or area.

3. The keypad displays the current day and time. Press **CMD**.
4. The keypad displays the current date. Press **CMD**.
5. At **TIME DAY DATE**, select **TIME** to change the time. The keypad displays -: **AM PM**. Enter the current time and select **AM** or **PM**. Enter the time using a 12-hour clock. Press **CMD**.
6. Select **DAY** to change the day of the week. Press **CMD**.
7. Select **DATE** to change the date. Press **CMD**.
8. At **MONTH:-**, enter up to 2 digits for the month and press **CMD**.
9. At **DAY:-**, enter up to 2 digits for the day and press **CMD**.
10. At **YEAR:-**, enter up to 2 digits for the year and press **CMD**.

10.10 Display Events

The system memory holds a maximum of 1,000 events that occurred over the last 45 days. Events older than 45 days are automatically deleted.

10.10.1 View Invalid Code Reporting with EasyEnroll

1. Access the User Menu
2. Press **CMD** until **DISPLAY EVENTS?** displays.
3. Press any select key. The keypad displays **DISPLAY EVENTS? FRST LST SRT**.
 - **FRST**: View the oldest to newest events.
 - **LST**: View the newest to oldest events.
 - **SRT**: Sort through the events log.
4. The keypad displays the user code connected to that event and displays **ADD CODE? NO YES**.
5. Select **YES** and the keypad displays **USER CODES?** Select **NO** to exit the User Menu.
6. Enter an available user number or press the fourth select key or area to automatically assign a user number. Press **CMD**.
7. Press any top row select key or area to clear the default name and enter a new name.
8. Enter a **GROUP NO:**. The keypad displays **USER ADDED**.

10.11 Service Request

At **SERVICE REQUEST?**, press any select key or area. When **REQUEST MADE** displays, the request was successful.

10.12 Fire Drill

Fire Drill tests your system's bells and sirens and does not send a message to your monitoring station.

10.12.1 Start a Fire Drill Test

1. Access the User Menu.
2. Press **CMD** until **FIRE DRILL?** displays, then press any select key or area.
3. Select **YES** to start the test. Enter your user code and press **CMD** to end the test.

11 Evacuation Plan

The National Fire Protection Association recommends that you establish an emergency evacuation plan to safeguard lives in the event of a fire or other emergency.

11.1 Draw a Floor Plan

On a clean sheet of paper, draw the walls, windows, doors, and stairs of your home or business. Draw any obstacles, such as large furniture and appliances, that a person may encounter while existing the building.

11.2 Develop Escape Routes

Determine at least two routes the occupants in each room can take to safely escape. Routes can include doors and easily opened windows. If the window is high off the ground, an escape ladder should be provided. Draw arrows on the floor pan to show escape routes from each room.

11.3 Decide Where to Meet

Prearrange a meeting place outside and away from where emergency personnel are likely to be working. Good locations include a neighbor's house or across the street. Always perform a head count to ensure all occupants safely exited.

 **Caution:** Never enter a burning building. If the head count shows one or more people are missing, tell authorities immediately. Never enter a building to look for someone.

11.4 Practice Escape Plans

For an escape plan to be effective, everyone should practice escape routes from each room.

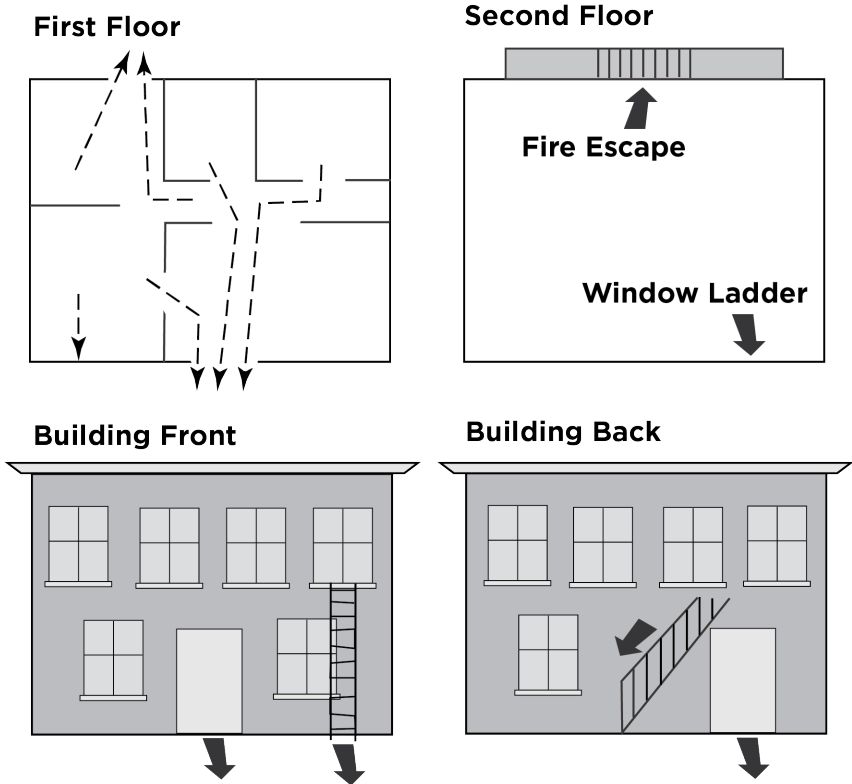

8 Escape Plan Example

11.5 Get Out Early

The best way to survive a fire or other emergency is to get out early. A fire alarm system installation with smoke and carbon monoxide detectors in each room can greatly decrease your risk of loss or injury.

12 Appendix

12.1 User Authority Descriptions

AUTHORITY	DESCRIPTION
Temp User Code	Apply an expiration date and time to a user code.
Re-Arm Delay	Delay automatic re-arming when the user disarms an area outside of a schedule.
Secondary Language	Apply a secondary language to a user's credentials.
Wi-Fi Setup	Add, remove, or test Wi-Fi on your system.
Inactive User Audit	This option allows you to choose the number of days a user code can remain unused before the panel sends an Inactive User Code message to the receiver and changes the user code to inactive. The range is 0-425 days. The default is 0 (zero).

12.2 Add a User Code

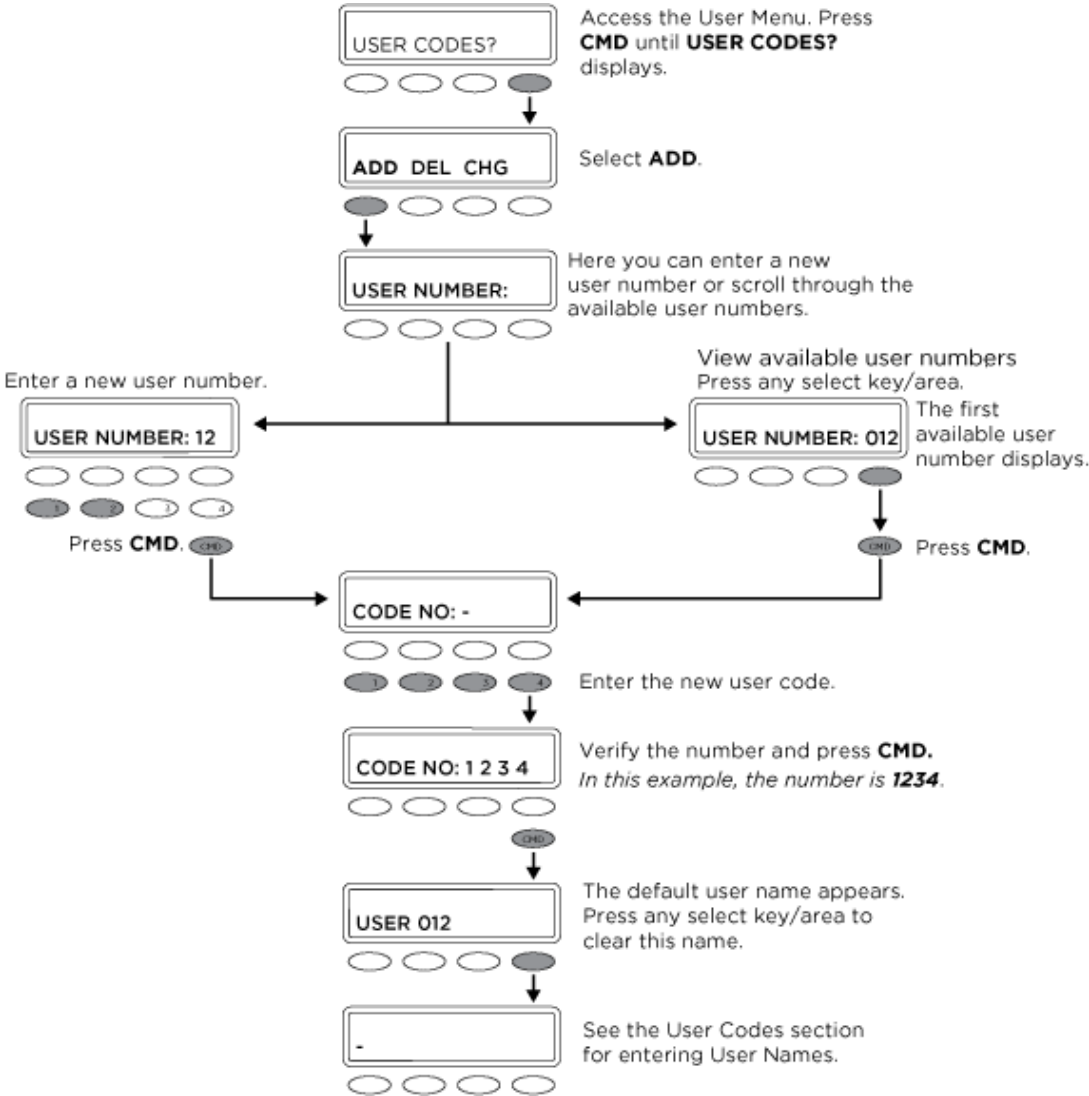

12.3 Change a User Code

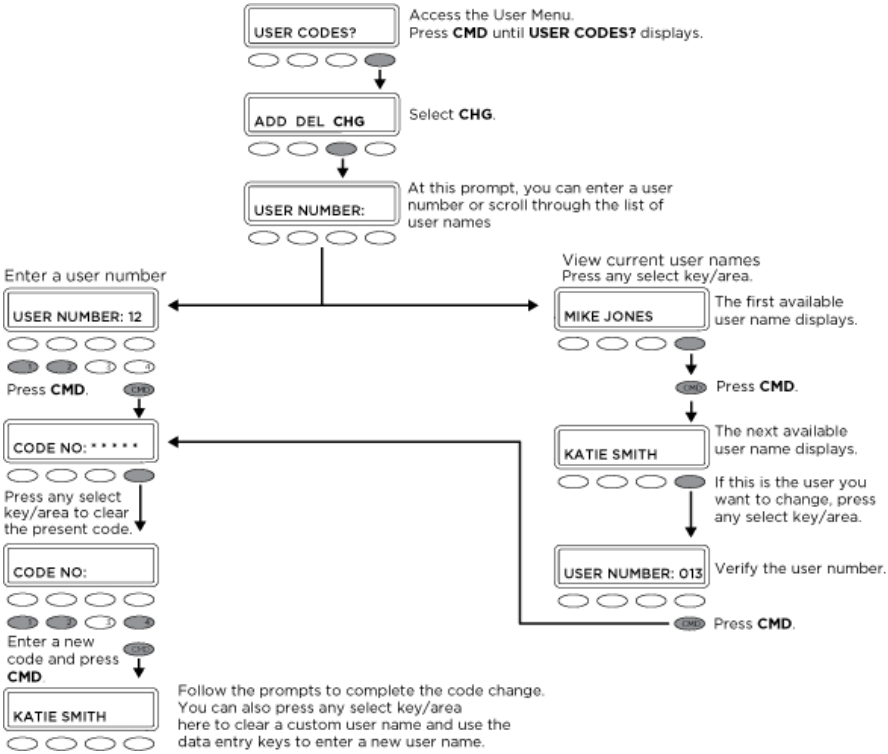

12.4 Common Keypad Displays

DISPLAY	DESCRIPTION
LOBAT	The battery in a wireless transmitter is low.
MISNG	Periodic reports from wireless transmitters are not being received by the panel.
WIRELESS TRBL	A device in your wireless system is not working correctly.
WIRELESS RECEIVER JAMMED TRBL	Your wireless receiver has detected a jamming signal while disarmed.

DISPLAY	DESCRIPTION
WIRELESS RECEIVER JAMMED ALARM	Your wireless receiver has detected a jamming signal while armed.
ALARM	A burglary zone has been tripped.
TRBL	There is a problem with a protection device or other system component.
ALARM NOT SENT	The alarm was aborted and a message was not sent to your monitoring station.
ALARM CANCELED	The alarm message sent to your monitoring station was aborted.
ALARM VERIFIED	A valid burglar alarm was manually verified by the user.
ENTER CODE OR PRESENT CARD	The system requires a user code or credential.
TRY AGAIN	The system does not recognize the user code, card, or pin or is not authorized for that user.
INVALID CODE	The code is not recognized.
INVALID GROUP	Attempted function that a user is not assigned.
INVALID AREA	Attempted door access to an area that a user is not assigned.
INVALID TIME	Attempted access by a user outside of an assigned schedule.
SYSTEM TROUBLE	There is a problem with one or more of your system components.
SYSTEM BUSY	Your system is performing another task of higher priority.

DISPLAY	DESCRIPTION
TEST IN PROGRESS	Your system is currently being tested.
HOME SYSTEM ON	The perimeter is armed.
PERIMETER ON	The perimeter is armed.
ALL SYSTEM ON	All areas and perimeter are armed.
SLEEP SYSTEM ON	The perimeter and interior areas are armed, excluding the bedroom area.

13 Glossary

13.1 Armed

A condition in which a system can be placed. When a system is armed, a tripped sensor will cause the panel to activate an alarm.

13.2 Card Reader

A device that reads a credential. The reader verifies the credential and grants access if authorized.

13.3 Credential

A device (access card, prox key, key fob) that allows for arming, disarming, and door access.

13.4 Disarmed

An unarmed condition in which a tripped zone will not activate an alarm.

13.5 False Alarm

An alarm signal initiated without the presence of an emergency and canceled by someone with an authorized user code. A false alarm report is sent to the emergency monitoring station.

13.6 Force Arm

An action that allows your system to arm, ignoring all faulted zones. If a faulted zone restores to normal condition, it will cause the system to report an alarm if tripped.

13.7 Hardwired Systems

All devices, sensors, and detectors in your system are connected with wire.

13.8 Monitoring Station

A remote monitoring location that receives alarms from alarmed systems. Your monitoring station informs the authorities of the emergency.

13.9 Outputs

Outputs are devices that react to a device or sensor's state.

13.10 Restored

A zone returns to its normal state.

13.11 System

A compilation of devices such as a panel, keypad, sensors, etc. that make an integrated security system.

13.12 Tripped

A device that faults during an armed state, causing an alarm.